

SECTION III
OLIVER
TSX SERIES

TRACTOR

Carbureters



MARVEL-SCHEBLER PRODUCTS DIVISION,
BORG-WARNER CORPORATION
DECATUR, ILLINOIS, U. S. A.

Warranty

Marvel-Schebler Products Division, Borg-Warner Corporation, warrant its carbureters against defects in material and workmanship for a period of ninety days. Defective merchandise will be replaced without charge but labor charges incurred in the removal, disassembly or reinstallation of such products will not be allowed. No merchandise can be returned without written permission from the factory, transportation charges must be prepaid. The factory shall be the sole judge of defects in products returned.

A ten per cent handling charge will be made for all merchandise returned that is not defective. All prices are subject to change without notice, and we reserve the right to limit quantities and to make partial shipments unless specifically instructed otherwise. The obligation of the company under this warranty is limited to replacing at the factory, any complete units or parts thereof which shall be returned and which our examination shall disclose to have been defective.

Introduction...

This section of the master manual is an individual parts catalog of all service parts for Marvel-Schebler carbureters listed on the identification charts. The catalog is divided into groups of carbureters; each group containing an identification chart, an exploded drawing of a composite carbureter, and a parts list. Each part in the illustration bears a reference number which keys together the illustration and parts list.

NOTE: The illustration does not represent any specific carbureter within a series, but is typical of all of them. All parts that look different are shown adjacent to the part of the basic carbureter that they replace.

TO USE THE CATALOG

- (1) Locate the group which contains the carbureter in question by referring to the identification charts.
- (2) Visually locate the part desired in the exploded drawing and note its reference number.
- (3) Turn to the parts list opposite the reference number of the part for its complete part name and part number.

OLIVER — TRACTOR CARBURETERS

ISSUED MARCH 1953

Model Application	Engine	Carbureter Number	Fuel	Superseded by	Customer Part No.	◆Repair Kit No.	§Gasket Kit No.	Float Valve & Seat Assy
Harvester	Continental F162	TSX-35	Gasoline	AC-6636	286-620	16-613	233-536
Harvester	Waukesha IXA3	TSX-37	Gasoline	AC-6193	286-564	16-613	233-536
Harvester	Continental Y91	TSX-48	Gasoline	AC-6631	286-574	16-613	233-536
60	Waukesha	TSX-49	Gasoline	HS-393	286-571	16-592	233-536
30 Combine	Continental F209	TSX-69	Gasoline	AC-7459	286-599	16-613	233-536
Harvester	Continental F162	TSX-98	Distillate	AC-7801	286-600	16-592	233-536
60HC	Waukesha 160	TSX-120	Gasoline	HS-393A	286-597	16-592	233-536
60KD	TSX-138	Distillate	HS-393B	286-664	16-592	233-536
900HC	TSX-168	Distillate	AS-393F	286-712	16-594	233-543
88HC	TSX-181	Gasoline	TSX-374	KS-393	286-843	16-594	233-543
70HC	Waukesha	TSX-186	Gasoline	BS-393K	286-698	16-594	233-536
88KD	TSX-221	Distillate	KS-393A	286-867	16-654	233-543
Harvester Model 15 Grainmaster ...	Continental Y91	TSX-287	Gasoline	TSX-359	AC-8806	286-791	16-613	233-536
Harvester Model 15 Grainmaster ...	Continental Y91	TSX-359	Gasoline	AC-8806A	286-869	16-613	233-536
77HC	TSX-363	Gasoline	MS-393	286-886	16-592	233-536

◆The repair kit includes the throttle shaft, float valve and seat assembly, and the gasket kit.

§The flange gasket can be supplied separately. Specify the carbureter number when ordering.

BASIC SUBASSEMBLIES

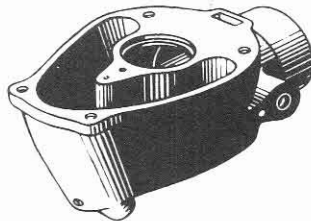

CARBURETER BODY ASSY

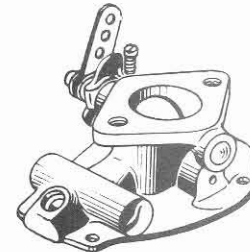

THROTTLE BODY & SHAFT ASSY

Carbureter Number	Marvel-Schebler Part Number	Oliver Part Number	Carbureter Number	Marvel-Schebler Part Number	Oliver Part Number
TSX-35	10-2340		TSX-35	227-763	
TSX-37	10-2063		TSX-37	227-986	
TSX-48	10-2064		TSX-48	227-670	
TSX-49	10-2135		TSX-49	227-705	
TSX-69	10-2342		TSX-69	227-765	
TSX-98	10-2378		TSX-98	227-789	
TSX-120	10-2477		TSX-120	227-846	
TSX-138	10-2589		TSX-138	227-846	
TSX-168	10-2705		TSX-168	227-941	
TSX-181	10-3167		TSX-181	227-1129	
TSX-186	10-2735		TSX-186	227-958	
TSX-221	10-3167		TSX-221	227-1178	
TSX-287	10-3070		TSX-287	227-1094	
TSX-359	10-3239		TSX-359	227-1158	
TSX-363	10-3277		TSX-363	227-1170	

Ref. No.	Part Name	Marvel-Schebler Part Number	Oliver Part Number	TSX-35	TSX-37	TSX-48	TSX-49	TSX-69	TSX-98	TSX-120	TSX-138	TSX-168	TSX-181	TSX-186	TSX-221	TSX-287	TSX-359	TSX-363
1	Body Assy — Carbureter(See Basic Subassembly)			1	1	1	1	1	1	1	1	1	1	1	1	1	1	1
2	Lever — Throttle, Loose	12-A14		1	1	1	1	1	1	1	1	1	1	1	1	1	1	1
2A	Lever — Throttle, Loose	12-A38		1	1	1	1	1	1	1	1	1	1	1	1	1	1	1
3	Shaft, Stop & Lever Assy — Throttle ...	13-780		1	1	1	1	1	1	1	1	1	1	1	1	1	1	1
3A	Shaft, Stop & Lever Assy — Throttle ...	13-792	HS-7606	1	1	1	1	1	1	1	1	1	1	1	1	1	1	1
3B	Shaft, Stop & Lever Assy — Throttle ...	13-822		1	1	1	1	1	1	1	1	1	1	1	1	1	1	1

OLIVER — TRACTOR
TSX-35 to TSX-363

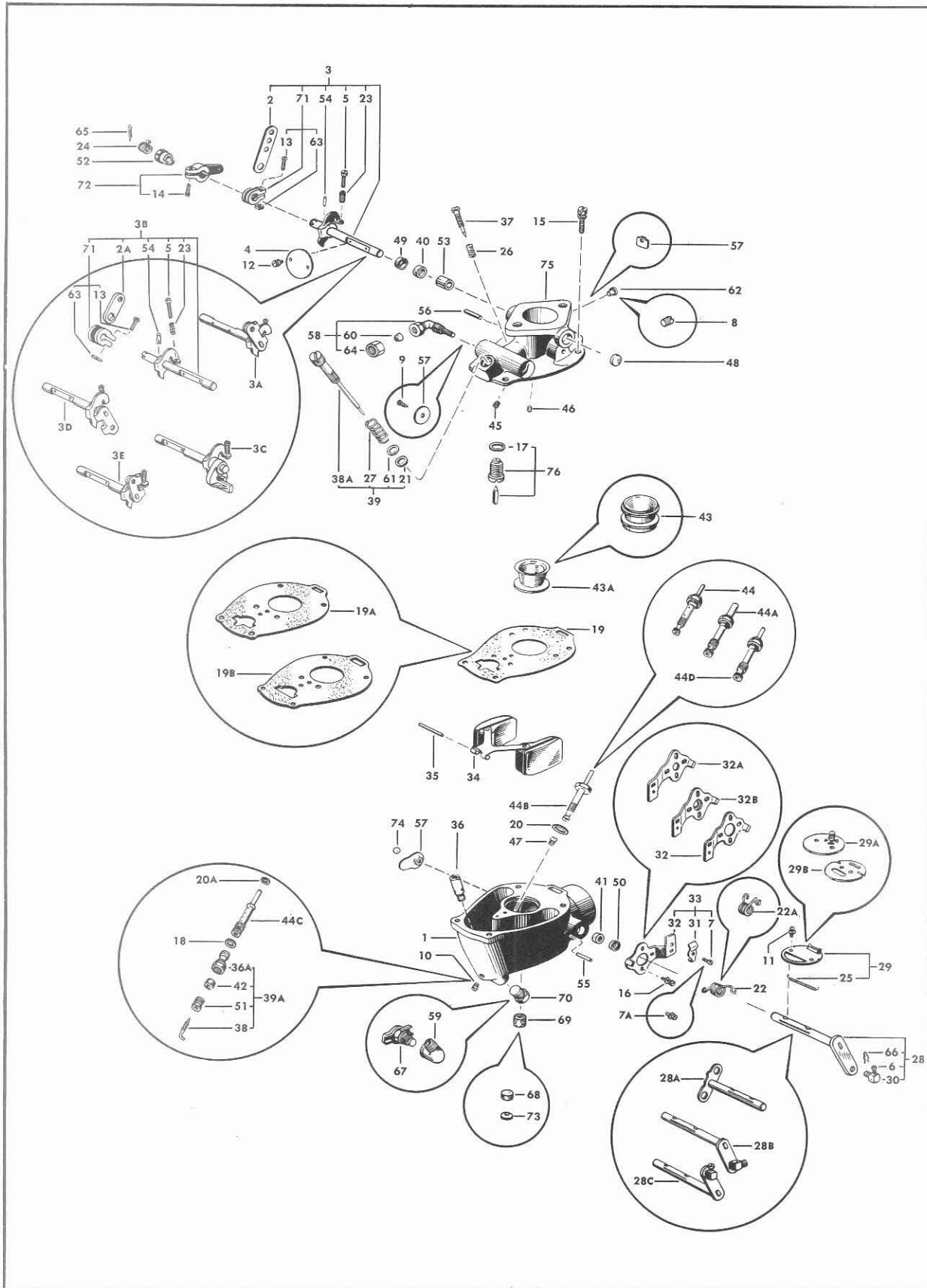

Marvel-Schebler Products Division, Borg-Warner Corporation, Decatur, Illinois, U. S. A.

Ref. No.	Part Name	Marvel-Schebler Part Number	Oliver Part Number	TSX-35	TSX-37	TSX-48	TSX-49	TSX-69	TSX-98	TSX-120	TSX-138	TSX-168	TSX-181	TSX-186	TSX-221	TSX-287	TSX-359	TSX-363
3C	Shaft, Stop & Lever Assy — Throttle	13-887	AS-7606A	-	-	-	-	-	-	-	-	-	1	-	-	-	-	-
3D	Shaft, Stop & Lever Assy — Throttle	13-896	BS-7606A	-	-	-	-	-	-	-	-	-	-	1	-	-	-	-
3E	Shaft, Stop & Lever Assy — Throttle	13-916	KS-7606	-	-	-	-	-	-	-	-	-	1	-	1	-	-	-
3E	Shaft, Stop & Lever Assy — Throttle	13-1012	MS-7606	-	-	-	-	-	-	-	-	-	-	-	-	-	-	1
4	Valve — Throttle (22°)	14-163	A-7634A	-	-	-	-	-	-	-	-	1	-	-	-	-	-	-
	(20°)	14-169	H-7634	1	1	1	1	1	1	1	1	-	-	1	-	-	-	1
	(15°)	14-175		-	-	-	-	-	-	-	-	-	-	-	-	1	1	-
	(15°)	14-225	K-7634	-	-	-	-	-	-	-	-	-	1	-	1	-	-	-
5	Screw — Throttle Stop (No. 8-32 x 3/4)	15-42	H-7646	1	1	1	1	1	1	1	1	1	1	1	1	1	1	1
6	Screw — Choke Swivel			-	-	-	-	-	-	1	1	1	1	1	1	-	-	1
	(No. 8-32 x 5/16)	15-108		-	-	-	-	-	-	1	1	1	1	1	1	-	-	1
	(No. 8-32 x 5/16)	15-285	H-7640	-	-	1	-	-	-	-	-	-	-	-	-	-	-	-
7	Screw — Choke Bracket			-	-	-	-	-	-	1	1	1	1	1	1	-	-	1
	(No. 8-32 x 5/16)	15-108		-	-	-	-	-	-	1	1	1	1	1	1	-	-	1
7A	Screw & Lock Washer Assy — Choke			-	-	1	-	-	-	-	-	-	-	-	-	-	-	-
	Bracket (No. 8-32 x 5/16)	15-A99		-	-	1	-	-	-	-	-	-	-	-	-	-	-	-
8	Screw — Idle Drilling (Headless, 1/4-28)	15-223	H-7647	-	1	1	-	1	-	-	-	-	-	-	-	1	1	-
	(Headless, 5/16-24)	15-274	A-7647	-	-	-	-	-	-	-	1	-	-	-	-	-	-	-
9	Screw — Drive, Numbering Plate			-	-	-	-	-	-	-	-	1	-	-	-	-	-	-
	(No. 2 x 1/4)	15-343		-	-	-	-	-	-	-	-	1	-	-	-	-	-	-
10	Screw — Drill Plug, Nozzle Hole			1	-	-	1	1	-	1	1	-	-	1	-	-	-	1
	(No. 8-32)	15-409		1	-	-	1	1	-	1	1	-	-	1	-	-	-	1
11	Screw & Lock Washer Assy — Choke			-	-	-	-	-	-	-	-	2	2	-	2	-	-	-
	Valve (No. 6-32 x 1/4)	15-483	C-7643A	-	-	-	-	-	-	-	-	2	2	-	2	-	-	-
	(No. 4-40 x 1/4)	15-A91	M-7642	2	2	2	2	2	2	2	2	-	-	2	-	2	2	2
12	Screw & Lock Washer Assy — Throttle			-	-	-	-	-	-	-	-	-	2	-	2	-	-	-
	Valve (No. 6-32 x 1/4)	15-483	C-7643A	-	-	-	-	-	-	-	-	-	2	-	2	-	-	-
	(No. 6-32 x 5/16)	15-A64	A-7642	-	-	-	-	-	-	-	-	2	-	-	-	-	-	-
	(No. 4-40 x 1/4)	15-A91	M-7642	2	2	2	2	2	2	2	2	-	-	2	-	2	2	2
13	Screw — Clevis Clamp (No. 10-24x5/8)	15-A55		1	1	1	-	1	1	-	-	-	-	-	-	1	1	-
14	Screw & Lock Washer Assy — Governor			1	1	1	-	1	1	-	-	-	-	-	-	1	1	-
	Lever Clamp (No. 12-24 x 5/8)	15-A82	M-7645	1	1	1	-	1	1	-	-	-	-	-	-	1	1	-
15	Screw & Lock Washer Assy — Throttle			4	4	4	4	4	4	4	4	4	4	4	4	4	4	4
	Body to Bowl (No. 12-24 x 5/8)	15-A82	M-7645	4	4	4	4	4	4	4	4	4	4	4	4	4	4	4
	(No. 12-24 x 3/4)	15-A85	K-7645	-	-	-	-	-	-	-	-	4	4	-	4	-	-	-
16	Screw & Lock Washer Assy — Choke			-	-	1	-	-	1	1	1	1	1	1	1	-	-	1
	Bracket to Body (No. 8-32 x 3/8)	15-A93	K-7644	-	-	1	-	-	1	1	1	1	1	1	1	-	-	1
17	Gasket — Float Valve Seat	16-4	H-7653	1	1	1	1	1	1	1	1	1	1	1	1	1	1	1
18	Gasket — Power Adjusting Needle			-	-	-	-	-	-	-	-	-	1	-	1	-	-	-
	Seat & Bowl Plug	16-47	K-7668	-	-	-	-	-	-	-	-	-	1	-	1	-	-	-
19	Gasket — Throttle Body to Bowl	16-80	H-7655	1	1	1	1	1	1	1	1	-	-	1	-	1	1	1
19A	Gasket — Throttle Body to Bowl	16-A12	A-7655	-	-	-	-	-	-	-	-	1	-	-	-	-	-	-
19B	Gasket — Throttle Body to Bowl	16-A41	K-7655	-	-	-	-	-	-	-	-	-	1	-	1	-	-	-
20	Gasket — Main Nozzle	16-449	H-7654	1	1	1	1	1	1	1	1	-	-	1	-	1	1	1
20A	Gasket — Main Nozzle	16-456	F-7654	-	-	-	-	-	-	-	-	-	1	-	1	-	-	-
20	Gasket — Main Nozzle	16-492	A-7654	-	-	-	-	-	-	-	-	1	-	-	-	-	-	-
21	Gasket — Power Adjusting Needle	16-491	H-7668	-	-	1	-	1	1	1	1	1	1	1	-	-	-	1
22	Spring — Choke Return	24-153	H-7630	-	-	1	-	-	1	1	-	-	-	1	-	-	-	1
22A	Spring — Choke Return	24-218		1	1	1	-	1	1	-	-	-	-	-	-	1	1	-
22	Spring — Choke Return	24-A3	A-7630	-	-	-	-	-	-	-	-	1	1	-	1	-	-	-
23	Spring — Throttle Stop Screw	24-262	H-7617	1	1	1	1	1	1	1	1	1	1	1	1	1	1	1
24	Spring — Governor Lever Tension	24-281		1	1	1	-	1	1	-	-	-	-	-	-	1	1	-
25	Spring — Choke Valve Flapper	24-292	A-7607	-	-	-	-	-	-	-	-	1	-	-	-	-	-	-
		24-425	H-7607	1	1	1	1	1	1	1	1	-	-	1	-	1	1	1
26	Spring — Idle Needle	24-340	H-7658	1	1	1	1	1	1	1	1	1	1	1	1	1	1	1

OLIVER — TRACTOR
TSX-35 to TSX-363

Ref. No.	Part Name	Marvel-Schebler Part Number	Oliver Part Number	TSX-35	TSX-37	TSX-48	TSX-49	TSX-69	TSX-98	TSX-120	TSX-138	TSX-168	TSX-181	TSX-186	TSX-221	TSX-287	TSX-359	TSX-363
27	Spring — Power Adjusting Needle	24-A1	M-7659	-	-	1	-	1	1	1	1	-	1	-	-	-	-	1
28	Shaft & Lever Assy — Choke	26-627	HS-7631	-	-	1	-	-	-	-	-	-	-	-	-	-	-	-
28A	Shaft & Lever Assy — Choke	26-635		1	1	1	-	1	1	-	-	-	-	-	-	1	1	-
28B	Shaft & Lever Assy — Choke	26-786		-	-	-	-	-	-	-	-	1	-	1	-	-	-	-
28B	Shaft & Lever Assy — Choke	26-787		-	-	-	-	-	-	-	1	-	-	-	-	-	-	-
28B	Shaft & Lever Assy — Choke	26-788		-	-	-	-	-	1	1	-	-	-	-	-	-	-	1
28C	Shaft & Lever Assy — Choke	26-789		-	-	-	-	-	-	-	-	-	1	-	-	-	-	-
29	Valve Assy — Choke	27-539	HS-7635	1	1	1	1	1	1	1	1	-	1	-	1	1	1	1
29A	Valve Assy — Choke	27-540	KS-7635	-	-	-	-	-	-	-	-	1	-	1	-	-	-	-
29B	Valve Assy — Choke	27-548	AS-7635	-	-	-	-	-	-	-	1	-	-	-	-	-	-	-
30	Swivel — Choke Lever	28-49	H-7620	-	-	1	-	1	1	1	1	1	1	1	-	-	-	1
31	Clip — Choke Bracket	29-81		-	-	1	-	1	1	1	1	1	1	1	-	-	-	1
32	Bracket — Choke	29-86		-	-	1	-	1	1	1	-	1	-	1	-	-	-	1
32A	Bracket — Choke	29-93		-	-	-	-	-	-	-	-	1	-	-	-	-	-	-
32B	Bracket — Choke	29-123		-	-	-	-	-	-	-	-	1	-	1	-	-	-	-
33	Bracket Assy — Choke	29-520	HS-7609	-	-	1	-	-	-	-	-	-	-	-	-	-	-	-
		29-544		-	-	-	-	-	1	1	-	1	-	1	-	-	-	1
		29-547		-	-	-	-	-	-	-	-	1	-	1	-	-	-	-
		29-548		-	-	-	-	-	-	-	1	-	-	-	-	-	-	-
34	Float & Lever Assy	30-600	HS-7605	1	1	1	1	1	1	1	1	-	1	-	1	1	1	1
		30-621	AS-7605	-	-	-	-	-	-	-	1	-	-	-	-	-	-	-
		30-631	KS-7605	-	-	-	-	-	-	-	1	-	1	-	-	-	-	-
35	Shaft — Float Lever	32-16	F-7626	-	-	-	-	-	-	-	1	1	1	1	-	-	-	-
		32-27	H-7626	1	1	1	1	1	1	1	1	1	1	1	1	1	1	1
36	Seat — Power Adjusting Needle	36-278	A-7636B	-	-	-	-	-	-	-	1	-	-	-	-	-	-	-
36A	Seat — Power Adjusting Needle	36-295	K-7615	-	-	-	-	-	-	-	-	1	-	-	-	-	-	-
36A	Seat — Power Adjusting Needle	36-308		-	-	-	-	-	-	-	-	-	-	1	-	-	-	-
37	Needle — Idle Adjusting	43-33	H-7628	1	1	1	1	1	1	1	1	-	1	1	1	1	1	1
		43-58	A-7628	-	-	-	-	-	-	-	1	-	-	-	-	-	-	-
38	Needle — Power Adjusting	43-134		-	-	-	-	-	-	-	-	1	-	1	-	-	-	-
38A	Needle Assy — Power Adjusting	43-627	MS-7614	-	-	1	-	1	1	1	-	1	-	-	-	-	-	1
38A	Needle Assy — Power Adjusting	43-631		-	-	-	-	-	-	-	1	-	-	-	-	-	-	-
39	Needle Assy — Power Adjusting (complete)	43-619		-	-	1	-	1	1	1	-	1	-	-	-	-	-	1
39	Needle Assy — Power Adjusting (complete)	43-620		-	-	-	-	-	-	-	1	-	-	-	-	-	-	-
39A	Needle Assy — Power Adjusting	43-624	KS-7614	-	-	-	-	-	-	-	-	1	-	-	-	-	-	-
39A	Needle Assy — Power Adjusting	43-635		-	-	-	-	-	-	-	-	-	-	1	-	-	-	-
40	Packing — Throttle Shaft	44-27	F-7611	-	-	-	-	-	-	-	-	1	-	1	-	-	-	-
		44-35		-	-	-	-	-	-	-	-	1	-	-	-	-	-	-
		44-38	H-7666	1	1	1	1	1	1	1	1	-	1	-	1	1	1	1
41	Packing — Choke Shaft	44-38	H-7666	-	-	-	-	-	-	-	-	1	1	1	-	-	-	-
		44-39	H-7611	1	1	1	1	1	1	1	1	-	1	-	1	1	1	1
42	Packing — Power Adjusting Needle	44-51	K-7636	-	-	-	-	-	-	-	-	1	-	1	-	-	-	-
43	Venturi (19/32" Diameter Throat)	46-424	H-7638	-	-	-	-	-	-	1	-	-	-	-	-	1	1	-
43	Venturi (5/8" Diameter Throat)	46-448		-	-	1	-	-	-	-	-	-	-	-	-	-	-	-
43A	Venturi (25/32" Diameter Throat)	46-457		1	-	-	-	-	-	-	-	-	-	-	-	-	-	-
43A	Venturi (11/16" Diameter Throat)	46-467		-	1	-	1	-	-	-	-	-	-	-	-	-	-	-
43A	Venturi (21/32" Diameter Throat)	46-473	H-7638A	-	-	1	-	-	1	-	-	-	1	-	-	-	-	-
43A	Venturi (23/32" Diameter Throat)	46-476		-	-	-	-	1	-	-	-	-	-	-	-	-	-	1
43A	Venturi (1-1/16" Diameter Throat)	46-490	A-7638	-	-	-	-	-	-	-	1	-	-	-	-	-	-	-
43A	Venturi (3/4" Diameter Throat)	46-A10	K-7635	-	-	-	-	-	-	-	-	1	-	-	-	-	-	-
43A	Venturi (7/8" Diameter Throat)	46-A11	K-7638A	-	-	-	-	-	-	-	-	-	-	1	-	-	-	-
44	Nozzle — Main	47-180		-	-	1	-	-	-	-	-	-	-	-	-	-	-	-

Ref. No.	Part Name	Marvel-Schebler Part Number	Oliver Part Number	TSX-35	TSX-37	TSX-48	TSX-49	TSX-69	TSX-98	TSX-120	TSX-138	TSX-168	TSX-181	TSX-186	TSX-221	TSX-287	TSX-359	TSX-363
44A	Nozzle — Main	47-221	A-7629A									1						
44B	Nozzle — Main	47-231	H-7629A							1								
44	Nozzle — Main	47-257	H-7629B								1							
44C	Nozzle — Main	47-318	K-7629									1						
44C	Nozzle — Main	47-341											1					
44D	Nozzle Assy — Main	47-589	H-7629	1	1	1	1	1										
44	Nozzle Assy — Main	47-608																1
44D	Nozzle Assy — Main	47-609																1
45	Jet — Idle	49-101-L	H-7613	1	1	1	1	1	1	1	1	1	1	1	1	1	1	1
		49-165	A-7613A									1					1	1
46	Jet — Economizer	49-145	H-7660		1			1		1	1			1				
		49-161							1									
		49-163		1														
		49-180					1											
		49-193				1												
		49-262	A-7660									1						
47	Jet — Power	49-153																
		49-173			1			1										1
		49-178				1												
		49-191	H-7669A								1							
		49-192	H-7669							1				1				
		49-198	H-7669B				1											1
		49-205			1													
		49-216							1									
48	Cup — Throttle Shaft	55-214											1					
		55-230	H-7641	1	1	1	1	1	1	1	1	1	1	1	1	1	1	1
49	Retainer — Throttle Shaft Packing	55-216	A-7667A									1						
		55-231	H-7667	1	1	1	1	1	1	1	1	1		1		1	1	1
		55-261	K-7641										1		1			
50	Retainer — Choke Shaft Packing	55-243	H-7612	1	1	1	1	1	1	1	1	1		1		1	1	1
51	Retainer — Power Adjusting Needle Packing	55-285	K-7637										1		1			
52	Bushing — Governor Lever	60-257		1	1	1		1	1								1	1
53	Bushing — Throttle Shaft	60-260	AR-7602A									2						
54	Pin — Throttle Shaft	62-61		1	1	1			1								1	1
55	Pin — Choke Stop	62-167	H-7633	1	1	1			1								1	1
56	Pin — Throttle Stop	62-167	H-7633	1	1	1	1	1	1	1	1	1	1	1	1	1	1	1
57	Plate — Numbering	(Specify TSX Number)		1	1	1	1	1	1	1	1	1	1	1	1	1	1	1
58	Fitting & Strainer Assy — Fuel Inlet	67-526		1	1	1			1									
59	Elbow — Street, Bowl Drain (1/8 NPT)	69-1																
60	Sleeve — Fuel Inlet Elbow	70-2		1	1	1			1								1	1
61	Washer — Flat, Power Adjusting Needle	78-299	H-7661				1		1	1	1	1	1	1	1	1	1	1
62	Plug — Idle Drilling	80-171		1				1	1		1	1	1	1	1	1	1	1
63	Nut — Clevis Clamp (No. 10-24)	81-1		1	1	1			1								1	1
64	Nut — Fuel Inlet Fitting	81-11		1	1	1			1								1	1
65	Pin — Cotter (Governor Spring Tension)	82-14		1	1	1			1								1	1
66	Cotter — Hairpin (Choke Swivel)	82-16	H-7619					1		1	1	1	1	1	1	1	1	1
67	Cock — Drain	87-3	F-7639															
		87-3A	F-7639										1		1			
		87-8	H-7639A															
68	Strainer — Fuel Drain	*95-40	H-7664	1	1	1	1	1	1	1	1	1	1	1	1	1	1	1
69	Strainer — Fuel Drain	*95-78		1	1	1	1	1	1	1	1	1	1	1	1	1	1	1
70	Plug — Bowl Drain	99-7	H-7639	1	1	1	1	1	1	1	1	1	1	1	1	1	1	1
71	Clevis Assy	121-504							1									
72	Lever Assy — Governor	155-565		1	1	1			1									
73	Plug — Expansion, Bowl Drain	*179-35	H-7665	1	1	1	1	1	1	1	1	1	1	1	1	1	1	1
74	Ball — Numbering Plate	206-36		1	1	1	1	1	1	1	1	1	1	1	1	1	1	1
75	Body & Shaft Assy — Throttle	(See Basic Subassembly)		1	1	1	1	1	1	1	1	1	1	1	1	1	1	1
76	Valve & Seat Assy — Float	233-536	HS-7623	1	1	1	1	1	1	1	1	1	1	1	1	1	1	1
		233-543	FS-7623										1		1			

* Production previous to July, 1947 used part number 95-40 with part number 179-35. These parts are not replaced with part number 95-78 but are still supplied for service.

OLIVER — TRACTOR CARBURETERS

ISSUED MARCH 1953

Model Application	Engine	Carbureter Number	Fuel	Superseded by	Customer Part No.	◆Repair Kit No.	§Gasket Kit No.	Float Valve & Seat Assy
88HC		TSX-374	Gasoline	TSX-181	KS-393B	285-867	16-654	233-543
77KD	Waukesha 185KL	TSX-380	Distillate		MS-393A	286-883	16-592	233-536
33 Combine	Continental F226	TSX-384	Gasoline		AC-9366	286-896	16-594	233-543
99	Oliver	TSX-394	Gasoline	TTX-21	AS-393G	286-921	16-594	233-543
90	Oliver	TSX-396	Distillate		AS-393H	286-935	16-594	233-543
OC9	Continental F226	TSX-397	Gasoline		142191	286-930	16-667	233-543
OC-12	Hercules JXLD	TSX-399	Gasoline		22972	286-931	16-594	233-543
OC-3	Hercules IXK-3 & Hercules IXB-3	TSX-403	Gasoline		C-116911	286-932	16-590	233-536
OC-6 Tractor	Waukesha 185GA	TSX-405	Gasoline		151432	286-1015	16-613	233-536
OC-3	Hercules IXB-3	TSX-406	Distillate		C-117144	286-933	16-597	233-536
66KD	Waukesha 180KL	TSX-418	Distillate		LS-393A	286-934	16-592	233-536
HG	Hercules IXB-3	TSX-472	Alcohol		117834	286-1012	16-597	233-536
Model 99 Tractor	Waukesha 195GL-1	TSX-477	Gasoline		7AS-393A	286-1000	16-594	233-543

◆The repair kit includes the throttle shaft, float valve and seat assembly, and the gasket kit.
§The flange gasket can be supplied separately. Specify the carbureter number when ordering.

BASIC SUBASSEMBLIES

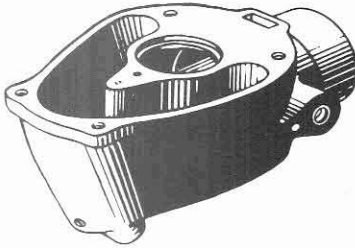

CARBURETER BODY ASSY

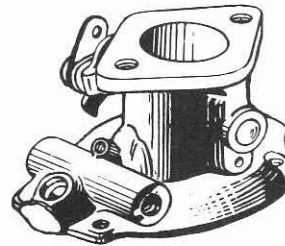

THROTTLE BODY & SHAFT ASSY

Carbureter Number	Marvel-Schebler Part Number	Oliver Part Number	Carbureter Number	Marvel-Schebler Part Number	Oliver Part Number
TSX-374	10-3167		TSX-374	227-1180	
TSX-380	10-3311		TSX-380	227-1184	
TSX-384	10-3257		TSX-384	227-1190	
TSX-394	10-3382		TSX-394	227-1221	
TSX-396	10-3382		TSX-396	227-1225	
TSX-397	10-3349		TSX-397	227-1208	
TSX-399	10-3348		TSX-399	227-1207	
TSX-403	10-3351		TSX-403	227-1209	
TSX-405	10-3393		TSX-405	227-1229	
TSX-406	10-3357		TSX-406	227-1212	
TSX-418	10-3379		TSX-418	227-1219	
TSX-472	10-3485		TSX-472	227-1277	
TSX-477	10-3534		TSX-477	227-1269	

Ref. No.	Part Name	Marvel-Schebler Part Number	Oliver Part Number	TSX-374	TSX-380	TSX-384	TSX-394	TSX-396	TSX-397	TSX-399	TSX-403	TSX-405	TSX-406	TSX-418	TSX-472	TSX-477
1	Body Assy — Carbureter															
2	Lever — Throttle, Loose	12-A131		-	-		-	-	-	-	-	-	-	-	-	-
3	Shaft, Stop & Lever Assy — Throttle	13-783		-	-	-	-	-	-	-		-	-	-	-	-
3A	Shaft, Stop & Lever Assy — Throttle	13-916			-	-	-	-	-	-	-	-	-	-	-	-
3A	Shaft, Stop & Lever Assy — Throttle	13-1012		-		-	-	-	-	-	-		-	-	-	-
3B	Shaft, Stop & Lever Assy — Throttle	13-1015		-	-	-	-	-	-		-	-	-	-	-	-
3C	Shaft, Stop & Lever Assy — Throttle	13-1020		-	-		-	-	-	-	-	-	-	-	-	-
3D	Shaft, Stop & Lever Assy — Throttle	13-1022		-	-	-			-	-	-	-	-	-	-	-
3E	Shaft, Stop & Lever Assy — Throttle	13-1026		-	-	-	-	-		-	-	-	-	-	-	-

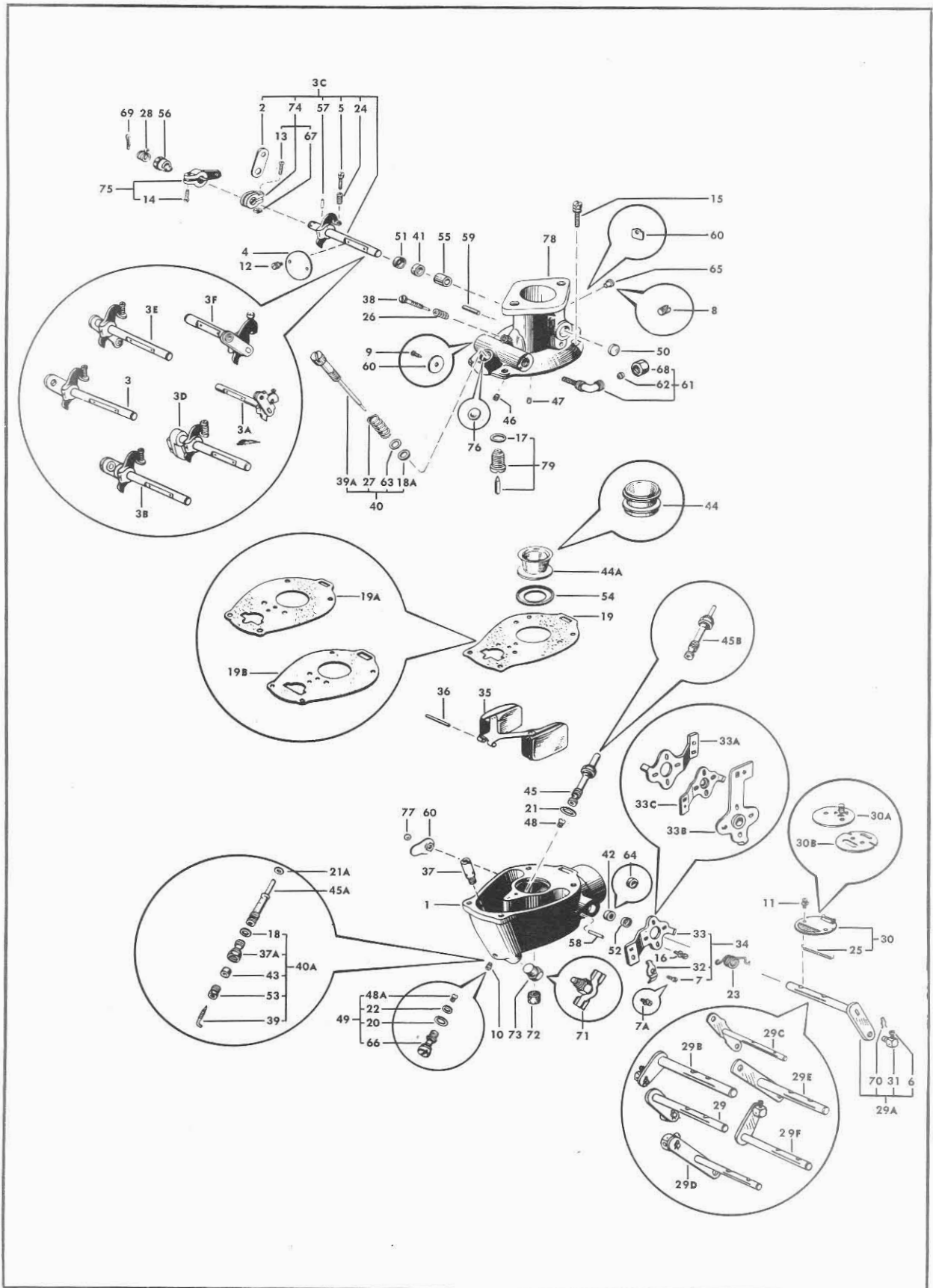

Marvel-Schebler Products Division, Borg-Warner Corporation, Decatur, Illinois, U. S. A.

OLIVER — TRACTOR
TSX-374 to TSX-477

Ref. No.	Part Name	Marvel-Schebler Part Number	Oliver Part Number	TSX-374	TSX-380	TSX-384	TSX-394	TSX-396	TSX-397	TSX-399	TSX-403	TSX-405	TSX-406	TSX-418	TSX-472	TSX-477
3F	Shaft, Stop & Lever Assy — Throttle	13-1068		-	-	-	-	-	-	-	-	-	-	-	-	-
4	Valve — Throttle (22°)	14-163		-	1	1	1	1	-	1	-	-	-	-	-	1
	(20°)	14-169		-	-	-	-	-	-	-	1	1	1	-	1	-
	(15°)	14-225		1	-	-	-	-	1	-	-	-	-	-	-	-
	(20°)	14-235		-	1	-	-	-	-	-	-	-	-	1	-	-
5	Screw — Throttle Stop (No. 8-32 x 3/4)	15-42		1	1	1	1	1	1	1	1	1	1	1	1	1
	(No. 8-32 x 7/8)	15-85		-	-	-	-	-	-	-	-	-	-	-	-	-
6	Screw — Choke Swivel (No. 8-32 x 5/16)	15-108		1	1	-	-	-	-	-	-	-	-	-	-	-
	(No. 8-32 x 5/16)	15-285		-	1	-	-	-	1	-	1	-	1	1	1	1
7	Screw — Choke Bracket (No. 8-32 x 5/16)	15-108		1	1	-	-	-	-	-	-	-	-	-	-	-
7A	Screw & Lock Washer Assy — Choke Bracket (No. 8-32 x 5/16)	15-A99		-	-	1	-	-	1	1	-	1	-	1	-	1
8	Screw — Idle Drilling (Headless, 1/4-28)	15-223		-	-	-	-	-	-	-	-	-	1	-	-	-
	(Headless, 5/16-24)	15-274		-	-	1	1	1	-	1	-	-	-	-	-	1
9	Screw — Drive, Numbering Plate (No. 2 x 1/4)	15-343		-	-	1	1	1	-	1	-	-	-	-	-	1
10	Screw — Drill Plug, Nozzle Hole (No. 8-32)	15-409		-	1	-	-	-	-	-	1	1	-	1	1	-
11	Screw & Lock Washer Assy — Choke Valve (No. 6-32 x 1/4)	15-483		2	-	2	2	2	2	2	-	-	-	-	-	2
	(No. 4-40 x 1/4)	15-A91		-	2	-	-	-	-	-	2	2	2	2	2	-
12	Screw & Lock Washer Assy — Throttle Valve (No. 6-32 x 1/4)	15-483		2	-	2	2	2	2	-	-	-	-	-	-	2
	(No. 6-32 x 5/16)	15-A64		-	-	-	-	-	-	2	-	-	-	-	-	-
	(No. 4-40 x 1/4)	15-A91		-	2	-	-	-	-	-	2	2	2	2	2	-
13	Screw — Clevis Clamp (No. 10-24 x 5/8)	15-A55		-	-	1	-	-	-	-	-	-	-	-	-	-
14	Screw & Lock Washer Assy — Governor Lever Clamp (No. 12-24 x 5/8)	15-A82		-	-	1	-	-	-	-	-	-	-	-	-	-
15	Screw & Lock Washer Assy — Throttle Body to Bowl (No. 12-24 x 5/8)	15-A82		-	4	-	-	-	-	4	4	4	4	4	4	-
	(No. 12-24 x 3/4)	15-A85		4	-	4	4	4	4	4	-	-	-	-	-	4
16	Screw & Lock Washer Assy — Choke Bracket to Body (No. 8-32 x 3/8)	15-A93		1	1	1	-	-	1	1	-	1	-	1	-	1
17	Gasket — Float Valve Seat	16-4		1	1	1	1	1	1	1	1	1	1	1	1	1
18	Gasket — Power Adjusting Needle	16-47		1	-	-	-	-	-	-	-	-	-	-	-	-
18A	Gasket — Power Adjusting Needle	16-491		-	1	-	1	1	-	-	-	1	1	1	1	1
19	Gasket — Throttle Body to Bowl	16-80		-	1	-	-	-	-	-	1	1	1	1	1	1
19A	Gasket — Throttle Body to Bowl	16-A12		-	-	1	1	1	-	1	-	-	-	-	-	1
19B	Gasket — Throttle Body to Bowl	16-A41		1	-	-	-	-	1	-	-	-	-	-	-	-
20	Gasket — Nozzle Plug & Power Jet Retainer (lower)	16-294		-	-	-	-	-	1	-	-	-	-	-	-	-
21	Gasket — Main Nozzle	16-449		-	1	-	-	-	-	1	1	1	1	1	1	1
21A	Gasket — Main Nozzle	16-456		1	-	-	-	-	1	-	-	-	-	-	-	-
21	Gasket — Main Nozzle	16-492		-	-	1	1	1	-	1	-	-	-	-	-	1
22	Gasket — Nozzle Plug & Power Jet Retainer (upper)	16-A152		-	-	-	-	-	1	-	-	-	-	-	-	-
23	Spring — Choke Return	24-153		-	1	-	-	-	-	-	-	1	-	1	-	-
		24-213		-	-	1	-	-	-	-	1	-	-	-	-	1
		24-A3		1	-	-	-	-	1	-	-	-	-	-	-	-
		24-A40		-	-	-	-	-	-	-	1	-	1	-	1	-
		24-A107		-	-	-	1	1	-	-	-	-	-	-	-	-
24	Spring — Throttle Stop Screw	24-262		1	1	1	1	1	1	1	1	1	1	1	1	1
25	Spring — Choke Valve Flapper	24-292		-	-	1	1	1	-	1	-	-	-	-	-	1
		24-425		-	1	-	-	-	-	-	1	1	1	1	1	1
26	Spring — Idle Needle	24-340		1	1	1	1	1	1	1	1	1	1	1	1	1
27	Spring — Power Adjusting Needle	24-A1		1	1	1	1	1	-	-	-	-	1	1	1	1
28	Spring — Governor Lever Tension	24-A37		-	-	1	-	-	-	-	-	-	-	-	-	-
29	Shaft & Lever Assy — Choke	26-610		-	-	-	-	-	-	-	-	-	-	-	-	1
29A	Shaft & Lever Assy — Choke	26-627		-	-	-	-	-	-	-	-	1	-	1	-	-
29B	Shaft & Lever Assy — Choke	26-653		-	-	-	-	-	-	-	1	-	-	-	-	-
29C	Shaft & Lever Assy — Choke	26-718		-	-	-	-	-	-	-	1	-	1	-	1	-
29D	Shaft & Lever Assy — Choke	26-748		-	-	1	-	-	-	-	-	-	-	-	-	-
29E	Shaft & Lever Assy — Choke	26-761		-	-	-	1	1	-	-	-	-	-	-	-	-

Ref. No.	Part Name	Marvel-Schebler Part Number	Oliver Part Number	TSX-374	TSX-380	TSX-384	TSX-394	TSX-396	TSX-397	TSX-399	TSX-403	TSX-405	TSX-406	TSX-418	TSX-472	TSX-477
29F	Shaft & Lever Assy — Choke	26-763							1							
29A	Shaft & Lever Assy — Choke	26-786		1												
29A	Shaft & Lever Assy — Choke	26-788			1											
30	Valve Assy — Choke	27-539			1						1	1	1	1		
30A	Valve Assy — Choke	27-540		1					1							
30B	Valve Assy — Choke	27-548				1	1	1		1						1
31	Swivel — Choke Lever	28-49		1	1	1			1	1		1		1		1
32	Clip — Choke Bracket	29-81		1	1	1			1	1		1		1		1
33	Bracket — Choke	29-86			1							1		1		
33A	Bracket — Choke	29-95				1				1						1
33B	Bracket — Choke	29-115							1							
33C	Bracket — Choke	29-123		1												
34	Bracket Assy — Choke	29-520										1		1		
		29-521				1				1						1
		29-543														
		29-544			1											
		29-547		1												
35	Float & Lever Assy	30-600			1						1	1	1	1		
		30-621				1	1	1		1						1
		30-631		1					1							
36	Shaft — Float Lever	32-16		1		1	1	1	1							1
		32-27			1					1	1	1	1	1		
37	Seat — Power Adjusting Needle	36-278					1	1								1
37A	Seat — Power Adjusting Needle	36-296		1												
37	Seat — Power Adjusting Needle	36-297								1						
38	Needle — Idle Adjusting	43-33		1	1			1		1	1	1	1	1		
		43-58				1	1	1		1						1
39	Needle — Power Adjusting	43-134		1					1							
39A	Needle Assy — Power Adjusting	*43-627			1						1	1	1	1		
		**43-631					1	1		1						1
		***43-645							1							
40	Needle Assy — Power Adjusting (complete)	*43-619			1						1	1	1	1		
40	Needle Assy — Power Adjusting (complete)	**43-620					1	1		1						1
40A	Needle Assy — Power Adjusting	43-625		1												
41	Packing — Throttle Shaft	44-27		1					1							
		44-35				1	1	1		1						1
		44-38			1						1	1	1	1		
42	Packing — Choke Shaft	†44-38		1		1	1	1	1	1						1
		44-39			1						1	1	1	1		
43	Packing — Power Adjusting Needle	44-51		1												
44	Venturi (19/32" Diameter Throat)	46-424									1					
44A	Venturi (29/32" Diameter Throat)	46-438				1										
44A	Venturi (23/32" Diameter Throat)	46-476			1											
44A	Venturi (1-1/16" Diameter Throat)	46-490					1	1								1
44A	Venturi (13/16" Diameter Throat)	46-491								1						
44A	Venturi (13/16" Diameter Throat)	46-A5		1												
44A	Venturi (7/8" Diameter Throat)	46-A11							1							
45	Nozzle — Main	47-199				1										
45	Nozzle — Main	47-221					1									1
45A	Nozzle — Main	47-318							1							
45A	Nozzle — Main	47-343		1												
45	Nozzle — Main	47-365						1								
45B	Nozzle Assy — Main	47-594									1			1		
45B	Nozzle Assy — Main	47-608										1				
45	Nozzle Assy — Main	47-694								1						
45B	Nozzle Assy — Main	47-712			1									1		

* For altitude adjustment on models TSX-403 and TSX-405.
 ** For altitude adjustment on model TSX-399.
 *** For altitude adjustment on model TSX-397. Remove power jet retainer, 80-187, and install needle.
 † Replaced by 44-63 on TSX-374, -384, -394, -396, -397, -399, -477.

OLIVER — TRACTOR
TSX-374 to TSX-477

Ref. No.	Part Name	Marvel-Schebler Part Number	Oliver Part Number	TSX-374	TSX-380	TSX-384	TSX-394	TSX-396	TSX-397	TSX-399	TSX-403	TSX-405	TSX-406	TSX-418	TSX-472	TSX-477
46	Jet — Idle	49-101-L		1					1	1		1		1		
		49-165			1	1	1	1				1		1		1
47	Jet — Economizer	49-145						1								
		49-154				1		1								
		49-226										1				
		49-262								1						1
		49-264					1									
48	Jet — Power	49-158										1				
48	Jet — Power	49-159				1										
48	Jet — Power	49-164													1	
48	Jet — Power	49-173											1			
48	Jet — Power	49-188			1									1		
48	Jet — Power	49-196									1					
48	Jet — Power	49-205								1						
48A	Jet — Power	49-266						1								
49	Power Jet, Nozzle Plug, & Gasket Assy	49-509						1								
50	Cup — Throttle Shaft	55-214				1	1	1		1						1
		55-230			1						1	1	1	1	1	
51	Retainer — Throttle Shaft Packing	55-216				1	1	1		1						1
		55-231			1						1	1	1	1	1	
		55-261			1			1								
52	Retainer — Choke Shaft Packing	55-231					1	1								
		55-243				1					1	1	1	1	1	
53	Retainer — Power Adjusting Needle Packing	55-285			1											
54	Retainer — Venturi	55-328								1						
55	Bushing — Throttle Shaft	60-260					2	2	2							2
56	Bushing — Governor Lever	60-370				1										
57	Pin — Throttle Shaft	62-61				1										
58	Pin — Choke Stop	62-167					1	1			1		1		1	
58	Pin — Throttle Stop	62-167					1	1		1	1	1	1	1	1	1
59	Plate — Numbering	(Specify TSX Number)		1	1	1	1	1	1	1	1	1	1	1	1	1
60	Fitting & Strainer Assy — Fuel Inlet	67-526				1										
62	Sleeve — Fuel Inlet Elbow	70-2				1										
63	Washer — Flat, Power Adjusting Needle	78-299				1		1					1	1	1	
64	Plug — Choke Shaft	80-169							1							
65	Plug — Idle Drilling	80-171				1	1			1	1		1	1		
66	Retainer — Power Jet	80-187							1							
67	Nut — Clevis Clamp (No. 10-24)	81-1														
68	Nut — Fuel Inlet Fitting	81-11					1									
69	Pin — Cotter (Governor Spring Tension)	82-1					1									
70	Cotter — Hairpin (Choke Swivel)	82-16				1	1		1	1		1		1		1
71	Cock — Drain	87-3							1							
		87-3A					1							1	1	
72	Strainer — Fuel Drain	95-78				1	1	1	1	1	1	1	1	1	1	1
73	Plug — Bowl Drain	99-7				1			1	1	1					1
74	Clevis Assy	121-511					1									
75	Lever Assy — Governor	155-587														
76	Plug — Expansion	179-11								1	1	1				
77	Ball — Numbering Plate	206-36									1	1		1	1	
78	Body & Shaft Assy — Throttle	(See Basic Subassembly)				1	1	1	1	1	1	1	1	1	1	1
79	Valve & Seat Assy — Float	233-536				1					1	1	1	1	1	
		233-543				1										1

TEMPORARY SERVICE PARTS LIST - INSERT IN THE PROPER SECTION OF YOUR MANUAL.

604 SOS FY

Oliver Corporation, Cleveland

TKZ-733

PART NO.	QUAN.	PART NAME
10-4207	1	Carburetor Body Assembly
13-1250	1	Throttle Shaft Assembly
14-299	1	Fly - Throttle (15°)
15-42	1	Screw (#8-32 x 3/4 Fill. Head) (Throttle Adjusting)
15-108	1	Screw (#8-32 x 5/16 Hex. Head) (Choke Swivel)
15-483	4	Screw (#6-32 x 1/4 "Sems" Binding Head) (Choke Fly-2) (Thr. Fly-2)
15-485	4	Screw (#12-24 x 3/4 "Sems" Fill. Head) (Throttle Body to Bowl)
15-A93	1	Screw (#8-32 x 3/8 "Sems" Fill. Head) (Choke Bracket)
15-A270	1	Screw (#8-32 x 5/16 Hex. Head) (Choke Bracket Clip)
16-4	1	Gasket (Float Valve Seat)
16-47	1	Gasket (Main Adjusting Needle Seat & Bowl Plug)
16-456	1	Gasket (Nozzle)
16-441	1	Gasket (Throttle Body to Bowl)
16-654	1	Gasket Assortment (Service)
24-262	1	Spring (Throttle Stop Screw)
24-292	1	Spring (Choke Flapper Valve)
24-340	1	Spring (Idle Needle)
24-A3	1	Spring (Choke Return)
26-836	1	Choker Shaft Assembly
27-548	1	Choker Fly Assembly
28-49	1	Swivel - Choker
29-81	1	Clip - Choke Bracket
29-123	1	Bracket - Choker
29-551	1	Choker Bracket Assembly
30-739	1	Float & Lever Assembly
32-16	1	Shaft - Float
36-348	1	Main Adjusting Needle Seat & Bowl Plug
43-33	1	Needle - Idle Adjusting
43-182	1	Needle - Main Adjusting
43-678	1	Main Adjusting Needle, Seat, Packing & Packing Ret. Assy.
44-38	1	Packing - Choker Shaft
44-51	1	Packing - Main Adjusting Needle
44-68	1	Packing - Throttle Shaft
46-412	1	Venturi (15/16 Throat)
47-451	1	Main Nozzle
49-101-L	1	Idle Jet
49-164	1	Power Jet
55-261	1	Retainer - Throttle Shaft Packing
55-285	1	Retainer - Main Adjusting Needle Packing
55-358	1	Cup - Throttle Shaft Plug
80-169	1	Plug - Choke Shaft
80-171	1	Drill Plug (Name Plate & Idle Plug Hole)
82-16	1	Cotter - Choker Swivel
99-7	1	Drain Plug
227-1555	1	Throttle Body Assembly
233-543	1	Float Valve, Seat & Gasket Assembly - Matched
286-1238		Repair Kit

TEMPORARY SERVICE PARTS LIST - INSERT IN THE PROPER SECTION OF YOUR MANUAL

166 Power Unit		Oliver, Charles City #103302-AS	TSX-724
PART NO.	QUAN.	PART NAME	
10-4333	1	Carburetor Body Assembly	
13-1278	1	Throttle Shaft Assembly	
13-1280	1	Throttle Shaft & Lever Assembly	
14-273	1	Fly - Throttle (15°)	
15-42	1	Screw (#8-32 x 3/4 Fill. Head) (Throttle Adj.)	
15-483	4	Screw (#6-32 x 1/4 "Sems" Binding Head) (Choke Fly-2) (Thr. Fly-2)	
15-485	4	Screw (#12-24 x 3/4 "Sems" Fillister Head) (Thr. Body to Bowl)	
15-A297	2	Screw (#10-24 x 7/8 Hex. Hd. Slotted) (Gov. & Thr. Lever Clevis)	
16-4	1	Gasket (Float Valve Seat)	
16-47	1	Gasket (Main Adjusting Needle Seat & Bowl Plug)	
16-456	1	Gasket (Nozzle)	
16-441	1	Gasket (Throttle Body to Bowl)	
16-654	1	Gasket Assortment	
24-262	1	Spring (Throttle Stop Screw)	
24-340	1	Spring (Idle Needle)	
24-292	1	Spring (Choke Flapper Valve)	
24-A98	1	Spring (Governor Lever Tension)	
24-A107	1	Spring (Choke Return)	
26-761	1	Choke Shaft Assembly	
27-548	1	Choke Fly Assembly	
30-739	1	Float and Lever Assembly	
32-16	1	Shaft - Float	
36-375	1	Main Adjusting Needle Seat & Bowl Plug	
43-33	1	Needle - Idle Adjusting	
43-227	1	Needle - Main Adjusting	
43-713	1	Main Adjusting Needle, Seat, Packing & Packing Retainer Assembly	
44-38	1	Packing - Choke Shaft	
44-68	2	Packing - Throttle Shaft	
44-127	1	Packing - Main Adjusting Needle O-Ring	
46-A125	1	Venturi (29/32 Throat)	
47-A24	1	Main Nozzle	
49-101-L	1	Idle Jet	
49-264	1	Economizer Jet	
55-231	1	Retainer - Choke Shaft Packing	
55-261	2	Retainer - Throttle Shaft Packing	
62-157	2	Pin (Choke Stop-1) (Throttle Stop-1)	
78-44	2	Washer (Clevis Assembly)	
80-169	1	Plug-Choke Shaft	
80-171	1	Drill Plug (Name Plate and Idle Plug Hole)	
81-1	2	Nut - Clevis (Throttle Lever-1) (Governor Lever-1)	
99-7	1	Drain Plug	
121-501	1	Clevis Assembly (Throttle Lever)	
121-525	1	Clevis Assembly (Governor Lever)	
135-306	1	Governor Lever	
227-1659	1	Throttle Body Assembly	
239-543	1	Float Valve, Seat & Gasket Assembly, Matched	
286-1279	1	Repair Kit	

TEMPORARY SERVICE PARTS LIST - INSERT IN THE PROPER SECTION OF YOUR MANUAL

Gasoline Tractor Model 550,660

Oliver Corp., Charles City
#103318-AS

TSX-775

PART NO.	QUAN.	PART NAME
10-3964	1	Carbureter Body Assembly
13-1267	1	Throttle Shaft Assembly
14-273	1	Fly - Throttle (15°)
15-42	1	Screw (#8-32 x 3/4 Fillister Head)(Throttle Adjusting)
15-108	1	Screw (#8-32 x 5/16 Hex. Head)(Choke Swivel)
15-483	4	Screw (#6-32 x 1/4 "Sems" Binding Hd.)(Choke Fly-2)(Thr. Fly-2)
15-A85	4	Screw (#12-24 x 3/4 "Sems" Fill. Hd.)(Throttle Body to Bowl)
15-A93	1	Screw (#8-32 x 3/8 "Sems" Fillister Head)(Choke Bracket)
15-A270	1	Screw (#8-32 x 5/16 Hex. Head)(Choke Bracket Clip)
16-4	1	Gasket (Float Valve Seat)
16-47	1	Gasket (Main Adjusting Needle Seat & Bowl Plug)
16-456	1	Gasket (Nozzle)
16-A41	1	Gasket (Throttle Body to Bowl)
16-654	1	Gasket Assortment - Service
24-262	1	Spring (Throttle Stop Screw)
24-292	1	Spring (Choke Flapper Valve)
24-340	1	Spring (Idle Needle)
24-A3	1	Spring (Choke Return)
26-787	1	Choke Shaft Assembly
27-548	1	Choke Fly Assembly
28-49	1	Swivel - Choke
29-81	1	Clip - Choke Bracket
29-123	1	Bracket - Choke
29-551	1	Choke Bracket Assembly
30-739	1	Float & Lever Assembly
32-16	1	Shaft - Float
36-375	1	Main Adjusting Needle Seat & Bowl Plug
43-33	1	Needle - Idle Adjusting
43-713	1	Main Adjusting Needle, Seat, Packing & Packing Retainer Assembly
44-38	1	Packing - Choke Shaft
44-68	1	Packing - Throttle Shaft
44-127	1	Packing - Main Adjusting Needle (O-Ring)
46-A125	1	Venturi (29/32 Throat)
47-A24	1	Main Nozzle
49-101-L	1	Idle Jet
49-264	1	Economizer Jet
55-261	1	Retainer - Throttle Shaft Packing
55-358	1	Cup - Throttle Shaft Plug
80-169	1	Plug - Choke Shaft
80-171	1	Drill Plug (Name Plate & Idle Plug Hole)
82-16	1	Cotter - Choke Swivel
99-7	1	Drain Plug
227-1638	1	Throttle Body Assembly
233-543	1	Float Valve, Seat & Gasket Assembly - Matched
286-1252	1	Package Repair Kit - Service

TEMPORARY SERVICE PARTS LIST - INSERT IN THE PROPER SECTION OF YOUR MANUAL

Oliver Corp., Cleveland

TSX-791

PART NO.	QUAN.	PART NAME #604 808FS
10-4207	1	Carbureter Body Assembly
13-1250	1	Throttle Shaft Assembly
14-299	1	Fly - Throttle (15°)
15-42	1	Screw (#8-32 x 3/4 Fill. Head) (Throttle Adjusting)
15-108	1	Screw (#8-32 x 5/16 Hex. Head) (Choke Swivel)
15-483	4	Screw (#6-32 x 1/4 "Sems" Binding Head) (Choke Fly-2) (Thr.Fly-2)
15-A85	4	Screw (#12-24 x 3/4 "Sems" Fill.Head) (Throttle Body to Bowl)
15-A93	1	Screw (#8-32 x 3/8 "Sems" Fill. Head) (Choke Bracket)
15-A270	1	Screw (#8-32 x 5/16 Hex. Head) (Choke Bracket Clip)
16-4	1	Gasket (Float Valve Seat)
16-47	1	Gasket (Main Adjusting Needle Seat & Bowl Plug)
16-456	1	Gasket (Nozzle)
16-A41	1	Gasket (Throttle Body to Bowl)
16-654	1	Gasket Assortment (Service)
24-262	1	Spring (Throttle Stop Screw)
24-292	1	Spring (Choke Flapper Valve)
24-340	1	Spring (Idle Needle)
24-A3	1	Spring (Choke Return)
26-836	1	Choker Shaft Assembly
27-548	1	Choker Fly Assembly
28-49	1	Swivel - Choker
29-81	1	Clip - Choke Bracket
29-123	1	Bracket - Choker
29-551	1	Choker Bracket Assembly
30-739	1	Float & Lever Assembly
32-16	1	Shaft - Float
36-348	1	Main Adjusting Needle Seat & Bowl Plug
43-33	1	Needle - Idle Adjusting
43-182	1	Needle Main Adjusting
43-678	1	Main Adjusting Needle, Seat, Packing & Packing Ret. Assy.
44-38	1	Packing - Choker Shaft
44-51	1	Packing - Main Adjusting Needle
44-68	1	Packing - Throttle Shaft
46-A12	1	Venturi (15/16 Throat)
47-451	1	Main Nozzle
49-101-L	1	Idle Jet
49-164	1	Power Jet
55-261	1	Retainer - Throttle Shaft Packing
55-285	1	Retainer - Main Adjusting Needle Packing
55-358	1	Cup - Throttle Shaft Plug
80-169	1	Plug - Choke Shaft
80-171	1	Drill Plug (Name Plate & Idle Plug Hole)
82-16	1	Cotter - Choker Swivel
99-7	1	Drain Plug
227-1555	1	Throttle Body Assembly
233-543	1	Float Valve, Seat & Gasket Assembly - Matched
286-1238		Repair Kit

REPLACES TSX-738

SECTION III
OLIVER
TTX SERIES

TRACTOR

Carburetors

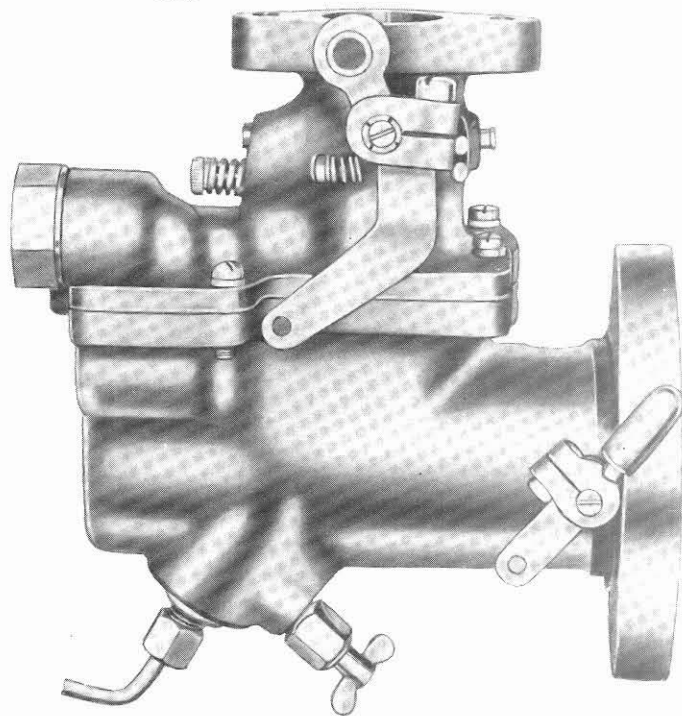
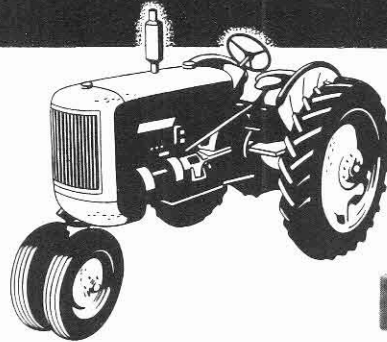

MARVEL-SCHEBLER PRODUCTS DIVISION,
BORG-WARNER CORPORATION
DECATUR, ILLINOIS, U. S. A.

OLIVER — TRACTOR
 TTX-18 to TTX-22

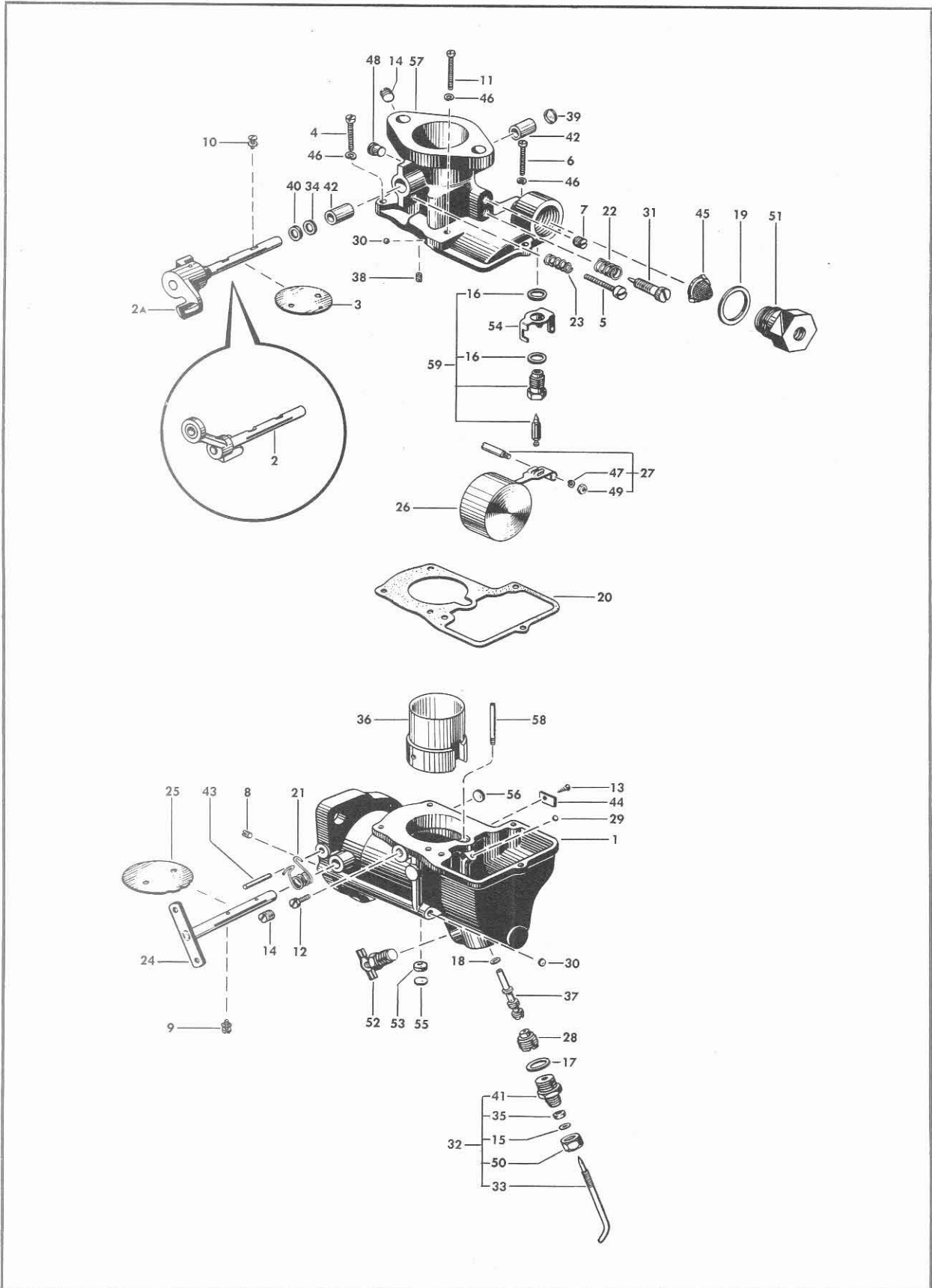

Marvel-Schebler Products Division, Borg-Warner Corporation, Decatur, Illinois, U. S. A.

OLIVER — TRACTOR CARBURETERS

ISSUED MARCH 1953

Model Application	Engine	Carbureter Number	Fuel	Superseded by	Customer Part No.	◆Repair Kit No.	§Gasket Kit No.	Float Valve & Seat Assy
80KD		*TTX-18	Distillate	CS-393D	286-554	16-622	X-2840
80HC		*TTX-19	Gasoline	CS-393C	286-556	16-622	X-2840
99AC		*TTX-21	Gasoline	AS-393E	286-557	16-622	X-2840
90KD		*TTX-22	Distillate	AS-393D	286-558	16-622	X-2840

◆The repair kit includes the throttle shaft, float valve and seat assembly, and the gasket kit.

§ The flange gasket can be supplied separately. Specify the carbureter number when ordering.

* NOTE — Complete carbureters can no longer be supplied. Service items, with the exception of castings, are still available.

BASIC SUBASSEMBLIES

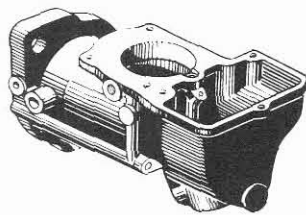

CARBURETER BODY ASSEMBLY

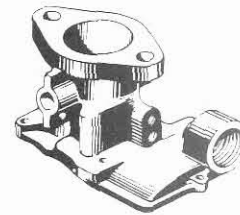

THROTTLE BODY & BUSHING ASSEMBLY

Carbureter Number	Marvel-Schebler Part Number	Oliver Part Number	Carbureter Number	Marvel-Schebler Part Number	Oliver Part Number
TTX-18	X-2902	CS-393D	TTX-18	X-2905	CS-7600
TTX-19	X-2923	CS-393C	TTX-19	X-2905	CS-7600
TTX-21	X-2935	AS-393E	TTX-21	X-2931	AS-7600
TTX-22	X-2936	AS-393D	TTX-22	X-2931	AS-7600

Ref. No.	Part Name	Marvel-Schebler Part Number	Part Number Oliver	TTX-18	TTX-19	TTX-21	TTX-22
1	Body Assy — Carbureter	(See Basic Subassembly)	1	1	1	1
2	Shaft, Stop & Lever Assy — Throttle	13-1089	CS-7606A	1	1	—	—
2A	Shaft, Stop & Lever Assy — Throttle	13-1107	AS-7606	—	—	1	1
3	Valve — Throttle (21°)	14-247	C-7634	1	1	1	—
	(21°)	14-252	A-7634	—	—	—	1
4	Screw — Throttle Body to Bowl (No. 10-24 x 7/8)	15-72	3	3	3	3
5	Screw — Throttle Stop (No. 10-24 x 7/8)	15-72	1	1	1	1
6	Screw — Throttle Body to Bowl (No. 10-24 x 3/4)	15-151	1	1	1	1
7	Screw — Drill Plug (Headless, 1/4-28)	15-223	C-7651	1	1	1	1
8	Screw — Drill Plug, Back Suction Channel (No. 10-32)	15-392	C-7612	1	1	1	1
9	Screw & Lock Washer Assy — Choke Valve (No. 6-32 x 1/4)	15-483	C-7643A	2	2	2	2
10	Screw & Lock Washer Assy — Throttle Valve (No. 6-32 x 1/4)	15-483	C-7643A	2	2	2	2
11	Screw — Throttle Body to Bowl (No. 10-24 x 1-1/8)	15-A225	C-7647	1	1	1	1
12	Screw — Venturi Retaining (No. 10-24 x 3/8)	15-A224	C-7642	1	1	1	1
13	Screw — Drive, Numbering Plate (No. 2 x 1/4)	S-1969B	1	1	1	1
14	Screw — Drill Plug (Headless, 5/16-24)	S-2083	C-7652	2	2	2	2
15	Gasket — Power Adjusting Needle	16-29	C-7668	1	1	1	1
16	Gasket — Float Valve Seat	16-294	2	2	2	2
17	Gasket — Power Adjusting Needle Retainer	16-364	C-7656	1	1	1	1
18	Gasket — Main Nozzle	16-456	1	1	1	1
19	Gasket — Strainer Nut	16-A168	C-7657	1	1	1	1
20	Gasket — Throttle Body to Bowl	16-A187	C-7655	1	1	1	1

OLIVER — TRACTOR
TTX-18 to TTX-22

Ref. No.	Part Name	Marvel-Schebler Part Number	Oliver Part Number	TTX-18	TTX-19	TTX-21	TTX-22
21	Spring — Choke Return	24-217	C-7630	1	1	1	1
22	Spring — Idle Needle	24-265		1	1	1	1
23	Spring — Throttle Stop Screw	24-A218	C-7659	1	1	1	1
24	Shaft Assy — Choke	26-798	CS-7631	1	1	1	1
25	Valve — Choke (15°)	27-227	C-7635	1	1	1	1
26	Float & Lever Assy	30-718	CS-7604	1	1	1	1
27	Shaft Assy — Float Lever	X-2404A	CS-7626	1	1	1	1
28	Seat — Power Adjusting Needle	36-344	A-7636	-	-	-	1
		S-2567		1	-	-	-
		S-2587	C-7636	-	1	-	-
		S-2592	A-7636A	-	-	1	-
29	Ball — Lead, Nozzle	37-4		1	1	1	1
30	Ball — Lead, Bowl Bleed	37-5		3	3	3	3
31	Needle Assy — Idle Adjusting	43-525		1	1	1	1
32	Needle Assy — Power Adjusting (complete)	43-667	CS-7614	1	1	1	1
33	Needle — Power Adjusting	S-2565		1	1	1	1
34	Packing — Throttle Shaft	44-27	C-7666	1	1	1	1
35	Packing — Power Adjusting Needle	S-257A		1	1	1	1
36	Venturi (1-1/16" Diameter Throat)	46-A135	C-7638	1	-	1	1
	(13/16" Diameter Throat)	T30-P	C-7638A	-	1	-	-
37	Nozzle — Main	47-403	A-7629	1	-	1	1
		S-2568	C-7629	-	1	-	-
38	Jet — Economizer	49-360	C-7660	1	1	-	1
39	Cup — Throttle Shaft	55-361	A-7641	1	1	1	1
40	Retainer — Throttle Shaft Packing	55-362	A-7667	1	1	1	1
41	Retainer — Power Adjusting Needle	S-2056	C-7637	1	1	1	1
42	Bushing — Throttle Shaft	60-261	A-7602	2	2	2	2
43	Pin — Choke Lever Stop	S-211F	C-7633	1	1	1	1
44	Plate — Numbering	(Specify TTX Number)		1	1	1	1
45	Strainer Assy	67-538	CS-7619	1	1	1	1
46	Washer — Lock, Body Screw	78-5		5	5	5	5
47	Washer — Lock, Float Lever Shaft	78-255		1	1	1	1
48	Plug — Idle Drilling	80-64		1	1	1	1
49	Nut — Float Lever Shaft	81-205	C-7648	1	1	1	1
50	Nut — Power Adjusting Needle Packing	S-27		1	1	1	1
51	Nut — Strainer	81-204	C-7640	1	1	1	1
52	Cock — Drain	87-3A	C-7639	1	1	1	1
53	Strainer — Fuel Drain	95-40		1	1	1	1
54	Bracket — Float Lever	P-1025A	C-7625	1	1	1	1
55	Plug — Expansion, Bowl Drain	179-35		1	1	1	1
56	Plug — Expansion, Choke Shaft	179-41	C-7611	1	1	1	1
57	Body & Bushing Assy — Throttle	(See Basic Subassembly)		1	1	1	1
58	Tube — Idle	229-155		1	-	-	-
		229-205	A-7613	-	-	-	1
		S-2491	C-7613	-	1	1	-
59	Valve & Seat Assy — Float	233-577	CS-7623	1	1	1	1

TEMPORARY SERVICE PARTS LIST - INSERT IN THE PROPER SECTION OF YOUR MANUAL

604 SOS FY

Oliver Corporation, Cleveland

TEX-733

PART NO.	QUAN.	PART NAME
10-4207	1	Carburetor Body Assembly
13-1250	1	Throttle Shaft Assembly
14-299	1	Fly - Throttle (15°)
15-42	1	Screw (#8-32 x 3/4 Fill. Head) (Throttle Adjusting)
15-108	1	Screw (#8-32 x 5/16 Hex. Head) (Choke Swivel)
15-483	4	Screw (#6-32 x 1/4 "Sems" Binding Head) (Choke Fly-2) (Thr. Fly-2)
15-A85	4	Screw (#12-24 x 3/4 "Sems" Fill. Head) (Throttle Body to Bowl)
15-A93	1	Screw (#8-32 x 3/8 "Sems" Fill. Head) (Choke Bracket)
15-A270	1	Screw (#8-32 x 5/16 Hex. Head) (Choke Bracket Clip)
16-4	1	Gasket (Float Valve Seat)
16-47	1	Gasket (Main Adjusting Needle Seat & Bowl Plug)
16-456	1	Gasket (Nozzle)
16-A41	1	Gasket (Throttle Body to Bowl)
16-654	1	Gasket Assortment (Service)
24-262	1	Spring (Throttle Stop Screw)
24-292	1	Spring (Choke Flapper Valve)
24-340	1	Spring (Idle Needle)
24-A3	1	Spring (Choke Return)
26-836	1	Choker Shaft Assembly
27-548	1	Choker Fly Assembly
28-49	1	Swivel - Choker
29-81	1	Clip - Choke Bracket
29-123	1	Bracket - Choker
29-551	1	Choker Bracket Assembly
30-739	1	Float & Lever Assembly
32-16	1	Shaft - Float
36-348	1	Main Adjusting Needle Seat & Bowl Plug
43-33	1	Needle - Idle Adjusting
43-182	1	Needle - Main Adjusting
43-678	1	Main Adjusting Needle, Seat, Packing & Packing Ret. Assy.
44-38	1	Packing - Choker Shaft
44-51	1	Packing - Main Adjusting Needle
44-68	1	Packing - Throttle Shaft
46-A12	1	Venturi (15/16 Throat)
47-451	1	Main Nozzle
49-101-L	1	Idle Jet
49-164	1	Power Jet
55-261	1	Retainer - Throttle Shaft Packing
55-285	1	Retainer - Main Adjusting Needle Packing
55-358	1	Cup - Throttle Shaft Plug
80-169	1	Plug - Choke Shaft
80-171	1	Drill Plug (Name Plate & Idle Plug Hole)
82-16	1	Cotter - Choker Swivel
99-7	1	Drain Plug
227-1555	1	Throttle Body Assembly
233-543	1	Float Valve, Seat & Gasket Assembly - Matched
286-1238		Repair Kit

TEMPORARY SERVICE PARTS LIST - INSERT IN THE PROPER SECTION OF YOUR MANUAL		
Gasoline Tractor Model 550,660		Oliver Corp., Charles City #103318-AS
		TSX-775
PART NO.	QUAN.	PART NAME
10-3964	1	Carbureter Body Assembly
13-1267	1	Throttle Shaft Assembly
14-273	1	Fly - Throttle (15°)
15-42	1	Screw (#8-32 x 3/4 Fillister Head)(Throttle Adjusting)
15-108	1	Screw (#8-32 x 5/16 Hex. Head)(Choke Swivel)
15-483	4	Screw (#6-32 x 1/4 "Sems" Binding Hd.)(Choke Fly-2)(Thr. Fly-2)
15-A85	4	Screw (#12-24 x 3/4 "Sems" Fill. Hd.)(Throttle Body to Bowl)
15-A93	1	Screw (#8-32 x 3/8 "Sems" Fillister Head)(Choke Bracket)
15-A270	1	Screw (#8-32 x 5/16 Hex. Head)(Choke Bracket Clip)
16-4	1	Gasket (Float Valve Seat)
16-47	1	Gasket (Main Adjusting Needle Seat & Bowl Plug)
16-456	1	Gasket (Nozzle)
16-A41	1	Gasket (Throttle Body to Bowl)
16-654	1	Gasket Assortment - Service
24-262	1	Spring (Throttle Stop Screw)
24-292	1	Spring (Choke Flapper Valve)
24-340	1	Spring (Idle Needle)
24-A3	1	Spring (Choke Return)
26-787	1	Choke Shaft Assembly
27-548	1	Choke Fly Assembly
28-49	1	Swivel - Choke
29-81	1	Clip - Choke Bracket
29-123	1	Bracket - Choke
29-551	1	Choke Bracket Assembly
30-739	1	Float & Lever Assembly
32-16	1	Shaft - Float
36-375	1	Main Adjusting Needle Seat & Bowl Plug
43-33	1	Needle - Idle Adjusting
43-713	1	Main Adjusting Needle, Seat, Packing & Packing Retainer Assembly
44-38	1	Packing - Choke Shaft
44-68	1	Packing - Throttle Shaft
44-127	1	Packing - Main Adjusting Needle (O-Ring)
46-A125	1	Venturi (29/32 Throat)
47-A24	1	Main Nozzle
49-101-L	1	Idle Jet
49-264	1	Economizer Jet
55-261	1	Retainer - Throttle Shaft Packing
55-358	1	Cup - Throttle Shaft Plug
80-169	1	Plug - Choke Shaft
80-171	1	Drill Plug (Name Plate & Idle Plug Hole)
82-16	1	Cotter - Choke Swivel
99-7	1	Drain Plug
227-1638	1	Throttle Body Assembly
233-543	1	Float Valve, Seat & Gasket Assembly - Matched
286-1252	1	Package Repair Kit - Service
62-167	1	Pin - Throttle Stop

TEMPORARY SERVICE PARTS LIST - INSERT IN THE PROPER SECTION OF YOUR MANUAL

166 Power Unit

Oliver, Charles City #103302-AS

TSX-724

PART NO.	QUAN.	PART NAME
10-4333	1	Carbureter Body Assembly
13-1278	1	Throttle Shaft Assembly
13-1280	1	Throttle Shaft & Lever Assembly
14-273	1	Fly - Throttle (15°)
15-42	1	Screw (#8-32 x 3/4 Fill. Head) (Throttle Adj.)
15-483	4	Screw (#6-32 x 1/2 "Sens" Binding Head) (Choke Fly-2) (Thr. Fly-2)
15-485	4	Screw (#12-24 x 3/4 "Sens" Fillister Head) (Thr. Body to Bowl)
15-A297	2	Screw (#10-24 x 7/8 Hex. Hd. Slotted) (Gov. & Thr. Lever Clevis)
16-4	1	Gasket (Float Valve Seat)
16-47	1	Gasket (Main Adjusting Needle Seat & Bowl Plug)
16-456	1	Gasket (Nozzle)
16-441	1	Gasket (Throttle Body to Bowl)
16-654	1	Gasket Assortment
24-262	1	Spring (Throttle Stop Screw)
24-340	1	Spring (Idle Needle)
24-292	1	Spring (Choke Flapper Valve)
24-898	1	Spring (Governor Lever Tension)
24-4107	1	Spring (Choke Return)
26-761	1	Choke Shaft Assembly
27-548	1	Choke Fly Assembly
30-739	1	Float and Lever Assembly
32-16	1	Shaft - Float
36-375	1	Main Adjusting Needle Seat & Bowl Plug
43-33	1	Needle - Idle Adjusting
43-227	1	Needle - Main Adjusting
43-713	1	Main Adjusting Needle, Seat, Packing & Packing Retainer Assembly
44-38	1	Packing - Choke Shaft
44-68	2	Packing - Throttle Shaft
44-127	1	Packing - Main Adjusting Needle O-Ring
46-4125	1	Venturi (29/32 Throat)
47-424	1	Main Nozzle
49-101-L	1	Idle Jet
49-264	1	Economizer Jet
55-231	1	Retainer - Choke Shaft Packing
55-261	2	Retainer - Throttle Shaft Packing
62-157	2	Pin (Choke Stop-1) (Throttle Stop-1)
78-44	2	Washer (Clevis Assembly)
80-169	1	Plug-Choke Shaft
80-171	1	Drill Plug (Name Plate and Idle Plug Hole)
81-1	2	Nut - Clevis (Throttle Lever-1) (Governor Lever-1)
99-7	1	Drain Plug
121-501	1	Clevis Assembly (Throttle Lever)
121-525	1	Clevis Assembly (Governor Lever)
133-306	1	Governor Lever
227-1659	1	Throttle Body Assembly
233-543	1	Float Valve, Seat & Gasket Assembly, Matched
286-1279	1	Repair Kit

TEMPORARY SERVICE PARTS LIST - INSERT IN THE PROPER SECTION OF YOUR MANUAL

1800 Agr. Tractor

Oliver - Charles City #104726AS

TSX-807

PART NO.	QUAN.	PART NAME
10-4426	1	Carbureter Body Assembly
13-1218	1	Throttle Shaft & Lever Assembly
14-163	1	Throttle - Fly (22°) 3/64 Offset
15-42	1	Screw (#8-32 x 3/4) Fill. Head (Throttle Adjusting)
15-274	1	Screw (5/16-24 x 5/32) Headless Plug
15-285	1	Screw (#8-32 x 5/16) Slotted Hex Head (Choke Swivel)
15-483	4	Screw (#6-32 x 1/4) Bind Head Sems (Choke Fly-2) (Throttle Fly-2)
15-A85	4	Screw (#12-24 x 3/4) Fill. Head Sems (Throttle Body to Bowl)
15-A93	2	Screw (#8-32 x 3/8) Pan Head Sems (Choke Bracket)
15-A270	1	Screw (#8-32 x 5/16) Slotted Hex. Head Sems (Choke Bracket Clip)
16-4	1	Gasket - Float Valve Seat
16-491	1	Gasket - Main Adjusting Needle
16-492	1	Gasket - Nozzle
16-A12	1	Gasket - Throttle Body to Bowl
16-594	1	Gasket Kit
24-262	1	Spring - Throttle Stop Screw
24-292	1	Spring - Choke Fly Flapper
24-340	1	Spring - Idle Needle
24-A1	1	Spring - Main Adjusting Needle Packing
24-A3	1	Spring - Choke Return
26-653	1	Choke Shaft & Lever Assembly
27-548	1	Choke Fly Assembly
28-49	1	Swivel - Choke
29-81	1	Clip - Choke Bracket
29-123	1	Bracket - Choke
29-551	1	Choke Bracket & Clip Assembly
30-621	1	Float & Lever Assembly
32-16	1	Shaft - Float
36-297	1	Seat - Main Adjusting Needle
43-58	1	Needle - Idle Adjusting
43-620	1	Main Adj. Needle Assembly Complete
43-631	1	Main Adj. Needle Assembly
44-65	1	Packing - Throttle Shaft
44-38	1	Packing - Choke Shaft
46-A1	1	Venturi (1" Throat)
47-416	1	Nozzle
49-479	1	Jet - Power
49-203	1	Jet - Idle
49-145	1	Jet - Economizer
55-214	1	Cup - Throttle Shaft
55-216	1	Retainer - Throttle Shaft Packing
55-370	1	Retainer - Float Valve Seat
60-260	2	Bushing - Throttle Shaft Service
62-167	1	Pin - Throttle Stop
78-299	1	Washer - Main Gas. Adjusting
82-16	1	Cotter - Choke Swivel
99-7	1	Drain Plug
227-1707	1	Throttle Body & Bowl Cover
233-581	1	Float Valve, Seat & Gasket Assembly Matched
286-1318	1	Repair Kit

TEMPORARY SERVICE PARTS LIST - INSERT IN THE PROPER SECTION OF YOUR MANUAL

Oliver, Charles City 105730AS

TSX-811

PART NO.	QUAN.	PART NAME
10-3964	1	Carbureter Body Assembly
13-1267	1	Throttle Shaft Assembly
14-273	1	Fly - Throttle (15°)
15-42	1	Screw (#8-32 x 3/4) Fillister Head (Throttle Adjusting)
15-108	1	Screw (#8-32 x 5/16) Slotted Hex. Head (Choke Swivel)
15-483	4	Screw (#6-32 x 1/4) "Sems" Binding Head (Choke Fly-2)(Thr. Fly-2)
15-A85	4	Screw (#12-24 x 3/4) "Sems" Fillister Head (Thr. Body to Bowl)
15-A93	1	Screw (#8-32 x 3/8) "Sems" Pan Head (Choke Bracket)
15-A270	1	Screw (#8-32 x 5/16)"Sems" Slotted Hex. Head(Choke Bracket Clip)
16-4	1	Gasket (Float Valve Seat)
16-47	1	Gasket (Main Adjusting Needle Seat & Bowl Plug)
16-456	1	Gasket (Nozzle)
16-A41	1	Gasket (Throttle Body to Bowl)
16-654	1	Gasket Assortment
24-262	1	Spring (Throttle Stop Screw)
24-292	1	Spring (Choke Flapper Valve)
24-340	1	Spring (Idle Needle)
24-A3	1	Spring (Choke Return)
26-787	1	Choke Shaft Assembly
27-548	1	Choke Fly Assembly
28-49	1	Swivel - Choke
29-81	1	Clip - Choke Bracket
29-123	1	Bracket - Choke
29-551	1	Choke Bracket Assembly
30-739	1	Float & Lever Assembly
32-16	1	Shaft - Float
36-375	1	Main Adjusting Needle Seat & Bowl Plug
43-33	1	Needle - Idle Adjusting
43-227	1	Needle - Main Adjusting
43-713	1	Main Adjusting Needle, Seat, Packing & Packing Retainer Assy.
44-38	1	Packing - Choke Shaft
44-68	1	Packing - Throttle Shaft
44-127	1	Packing - Main Adjusting Needle (O-Ring)
46-A125	1	Venturi (29/32 Throat)
47-467	1	Main Nozzle
49-203	1	Idle Jet
49-437	1	Economizer Jet
55-261	1	Retainer - Throttle Shaft Packing
55-358	1	Cup - Throttle Shaft Plug
62-167	1	Pin - Throttle Stop
80-169	1	Plug - Choke Shaft
80-171	1	Drill Plug (Name Plate and Idle Plug Hole)
82-16	1	Cotter - Choke Swivel
99-7	1	Drain Plug
227-1708	1	Throttle Body Assembly
233-543	1	Float Valve, Seat & Gasket Assembly, Matched
286-1325	1	Package Repair Kit
49-216	1	Power - Jet

